

# Forage transport trailers - HTW

HTW 35 / 40 / 45 / 50 / 65

**BERGMANN**

*...die Spezialisten*



# Forage transport trailers – HTW

Whole product range



- HTW 35 (S)



- HTW 40 (S)



- HTW 45 (S)



- HTW 50 (S)



- HTW 65 (S)



- HT-Specials



# Forage transport trailers – HTW

product range | Bogie-chassis



## HTW 35 (S)

- 34 m<sup>3</sup>
- 36.6 m<sup>3</sup> - Body extension
- Bogie chassis with parabolic springs and lowered pivot point
- 20 / 22 t GVW.
- 



## HTW 40 (S)

- 39 m<sup>3</sup>
- 42,1 m<sup>3</sup> - body extension
- Bogie chassis with parabolic springs and lowered pivot point
- 22 / 24 t GVW.
-

## High drawbar

- Series
- Mechanical drawbar suspension
  - absorbs shocks



## Low drawbar

- Option
- Attachment underneath the PTO
- Mechanical drawbar suspension
  - absorbs shocks





## Mechanical jack stand

- Series
- Easy to use
- Can be swivelled backwards
- No contact with the tire of the tractor



## Hydraulic jack stand

- Option
- Allows easy attachment and disconnection
- Can be swivelled backwards



## Bogie chassis

- Low pivot point
- Asymmetrical arrangement
- The front axle has a longer distance to the pivot point than the rear axle.
- Bumps and silos are more easily rolled over
- Ease of movement
- Traction and fuel savings

## 20 bis 22 t – Bogie chassis

- Series
- Axis square: 150 mm
- Wheelbase: 1640 mm
- Track width: 2100 mm
- Brake (Ø x width): 406 mm x 120 mm

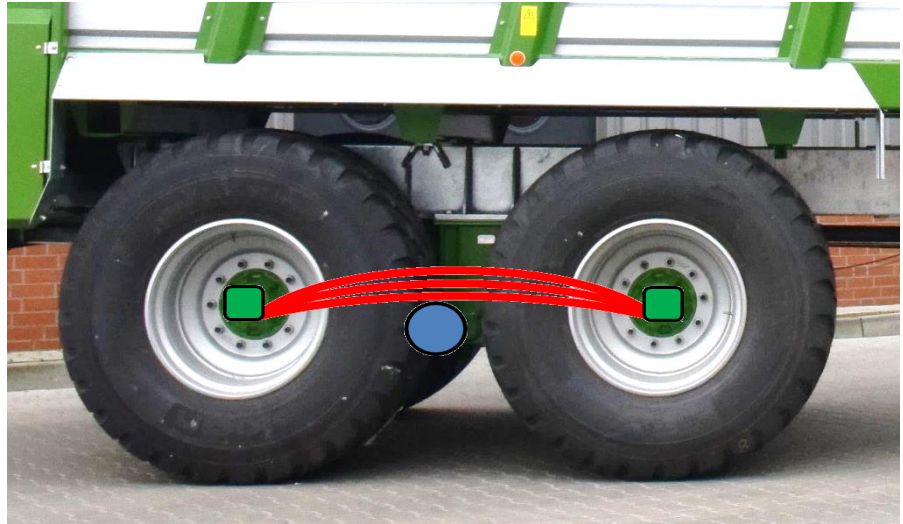

### 22 bis 24 t - Bogie chassis - reinforced

- Option
- Axis square: 150 mm
- Wheelbase: 1900 mm
- Track width: 2100 mm
- Brake ( $\varnothing$  x width): 420 mm x 180 mm





# HTW – Forage transport trailers

Product range | hydraulic chassis



## HTW 45 (S)

- 44 m<sup>3</sup>
- 48.6 m<sup>3</sup> – Body extension
- Chassis with hydraulic axle compensation
- 22 / 24 t GVW.



## HTW 50 (S)

- 44 m<sup>3</sup>
- 48.6 m<sup>3</sup> – Body extension
- Chassis with hydraulic axle compensation
- 32 / 34 t GVW.



## HTW 65 (S)

- 52.1 m<sup>3</sup>
- 56.4 m<sup>3</sup> – Body extension
- Chassis with hydraulic axle compensation
- 32 / 34 t GVW.



## Low drawbar

- Series
- Mechanical drawbar suspension
- High level of driving comfort
- Large distance between points of force application
- Low torques
  - minimal loads
  - minimal wear and tear
  - long service life
- Plastic sliding elements for lateral tensile forces



## Hydropneumatic drawbar suspension

- Option
- absorbs shocks and vibrations
- higher compensating travel than mechanical drawbar suspension



## Hydraulic jack stand

- Series
- Fast coupling and uncoupling of the vehicle, even when fully loaded
- Complete integration in the drawbar when not in use
- Ground clearance is fully retained
- High level of comfort





## Hydraulic axle compensation

- Series at HTW 45 / 50 / 65
- Option for HTW 40
- high compensation distance up to 300 mm
- Advantages of axle compensation:
  - Very calm and comfortable handling
  - If the obstacle is crossed with an axle, the chassis remains at a high level, the following axles can swing freely.
  - All cylinders have the same pressure – all the time!

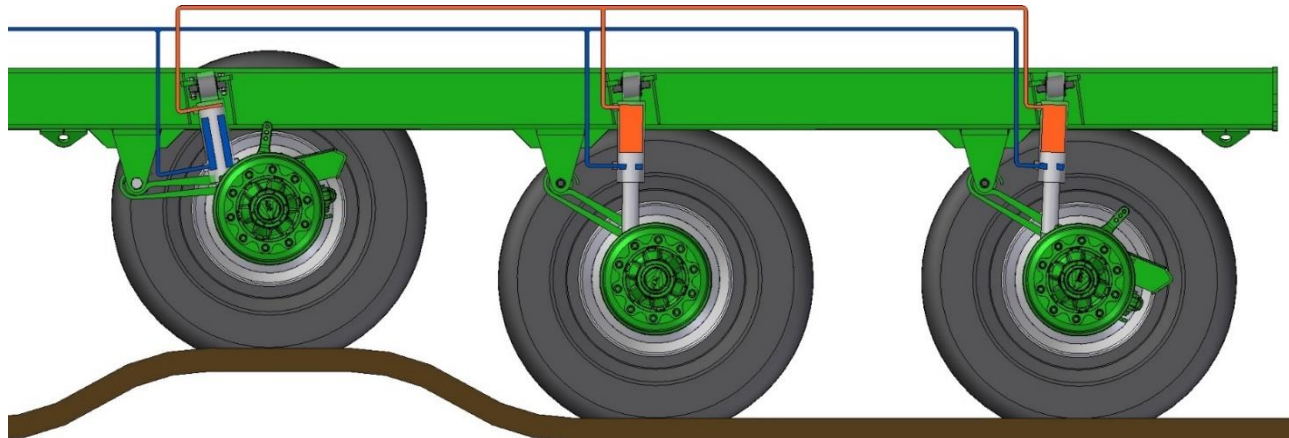

## Axle connection

- Robust axle connection to the chassis
- Good damping properties
- Maintenance-free
- Free of play
- Also installed in heavy-duty trucks, can be replaced quickly and easily
  - 4 screws instead of rusting bolts in a ball joint
  - better accessibility
  - in case of wear, the bearings can be changed, cylinder can continue to be used

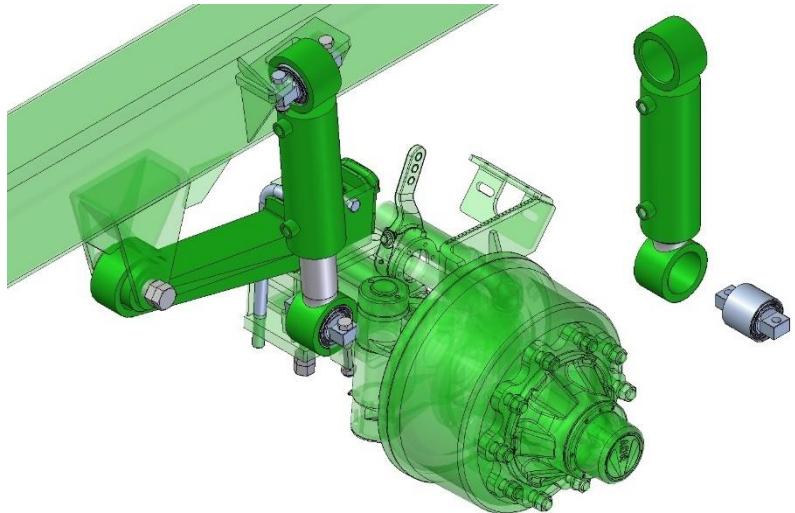
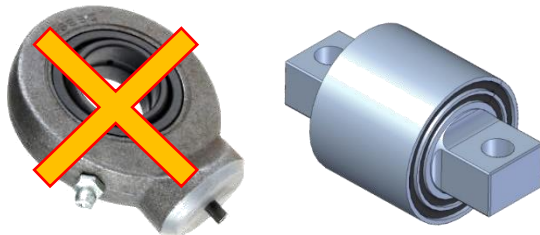



# Chassis

HTW 40 / 45 / 50 / 65

## 130 mm square axle

- Series:
  - 24 t tandem at HTW 45
  - 34 t tridem at HTW 50
- Wheelbase: 1810 mm
- Track gauge: 2100 mm
- Brake (Ø x width): 406 mm x 120 mm



## 150 mm square axle

- Series:
  - 34 t Tridem at HTW 65
- Option:
  - 24 t tandem at HTW 45
  - 34 t Tridem at HTW 50
- Wheelbase: 1810 mm
- Track gauge: 2100 mm
- Brake (Ø x width): 420 mm x 180 mm

# Chassis

HTW 40 / 45 / 50 / 65

## Lift axle

- Option
- Less wear on the tires of the first axle





## Wide-angle PTO cardan shaft

- Series: for S-vehicles (with dosing unit)
- Option: for vehicles without dosing unit with mechanical transport floor drive
- Optimum power transmission
- Foldable PTO shaft support



## Hose rack

- Extension arm for hose guide to the tractor
- Incl. parking position for hoses and cables
- Clear hose marking



## Follow-up steering axle

- Series
- The steering axle can be locked, for example, for road driving, use on slopes and for manoeuvring.



## Hydraulic forced steering

- Option
- Displacement steering
- The tyres are also steered when reversing
- One master cylinder with K50 clutch per steering axle



## Electronic forced steering

- Option
- Better handling on the road
- Steering angles adapt to the driving speed
- The tyres are also steered when reversing

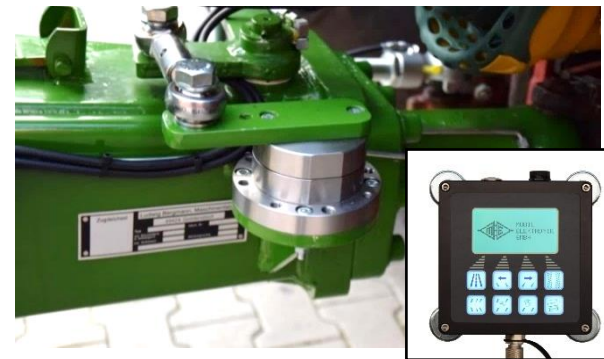



# Cargo space

HTW 35 / 40 / 45 / 50 / 65

**BERGMANN**

*...die Spezialisten*

## Front wall

- Optimum transparency of the bulkhead - even in difficult visibility conditions
- Generous viewing windows allow a perfect view of the cargo area
- Maintenance flap for transport floor
- Two viewing windows for checking the transport floor operation from the tractor seat
- Maintenance and cleaning work can be carried out easily



# Cargo space

HTW 35 / 40 / 45 / 50 / 65

**BERGMANN**

*...die Spezialisten*

## Front wall top flap

- Series
- Hydraulic operation
- 600 mm height
- 90° beam angle
- Simple and low-loss shredding possible



## Conical body

- Widening of the body towards the rear
- Recognizable by the distance between the transport floor chains and the side wall
- Reduction of friction between load and trapezoidal sheets
- Minimization of the force required for unloading
- Less wear on the side walls





# Scraper floor

HTW 35 / 40 / 45 / 50 / 65

## Scraper floor chains

- Solid round-link steel chain 14 x 50 mm
- Breaking load 100 t (25 t per chain)
- Stretched in pairs by the manufacturer
- Same running behavior
- High operational reliability
- Particularly tear-resistant due to special hardening at the ends of each chain link
- Returning chains under the body are guided on plastic rails
  - No damage to the paintwork below the platform
  - Smooth running
- Lateral guidance of the chains by plastic blocks
  - No movement of the chains when operating in an inclined position
  - Easy cleaning of the frame longitudinal members



# Scraper floor

HTW 35 / 40 / 45 / 50 / 65

**BERGMANN**

*...die Spezialisten*

## Automatic chain tensioners

- Series
- Good visibility from the driver's seat to the chain tensioners as well as good accessibility
  - Easy tensioning of the chain
- Spring-loaded
  - Protects the chains from damage
- Lubrication points are easily accessible from the outside
  - Easy lubrication of the transport floor chains



# Scraper floor

HTW 35 / 40 / 45 / 50 / 65

**BERGMANN**

*...die Spezialisten*

## Chain nuts

- Chains lie very deep (approx. 95 %) in the chain nuts
- Skipping of the chains is almost impossible
- integrierter Abstreifer
  - Material kann sich nicht in den Kettennüssen sammeln



## Scraper floor bars

- Closed bars
  - Sticky material can't get into the bars
- Bars are bolted to the chains
  - Easy to change when damaged
- Cranked bar holders
  - Bars pull under the material and are not lifted over it





# Scraper floor drive

HTW 35 / 40 / 45 / 50 / 65

**BERGMANN**

*...die Spezialisten*

## Hydraulic drive of all chains

- Series at HTW 35 / 40 (without dosing unit)
- Double-sided drive für low torsion forces on the scraper floor shaft

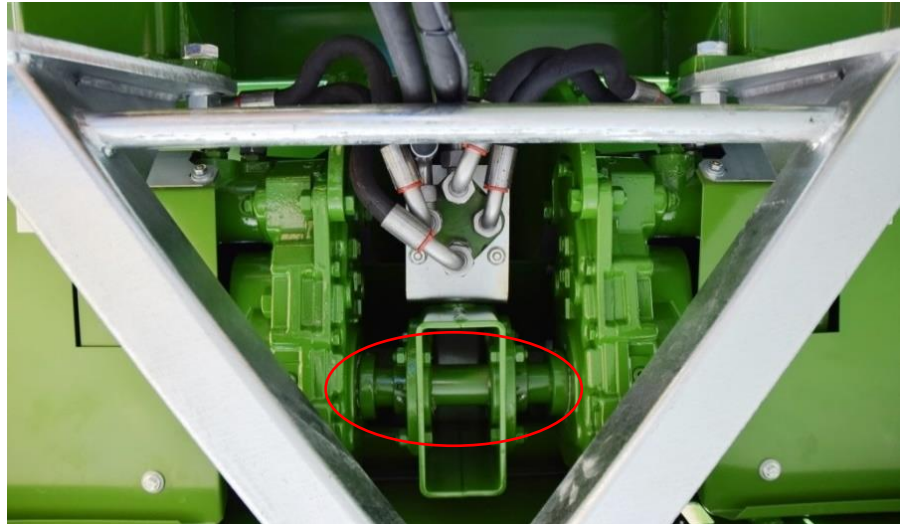

## Reverse unit for scraper floor

- Option
- Usage for example: Transport of straw bales etc.
- The chain will be tensioned in both turning directions



# Scraper floor drive

HTW 35 / 40 / 45 / 50 / 65

**BERGMANN**

*...die Spezialisten*

## Mechanical drive

- Series at all S-vehicles
- Series at HTW 45 / 50 / 65 (without dosing unit)
- Optional at HTW 35 / 40 (without dosing unit)
- Roller chain drive (1 ¼" chain)
  - High reserves even with heavy material
- Double-sided drive für low torsion forces on the scraper floor shaft
- Scraper floor speed: 16,3 m/min
- Fast emptying:
  - HTW 35 in ca. 40 sec empty
  - HTW 65 in ca. 55 sec empty

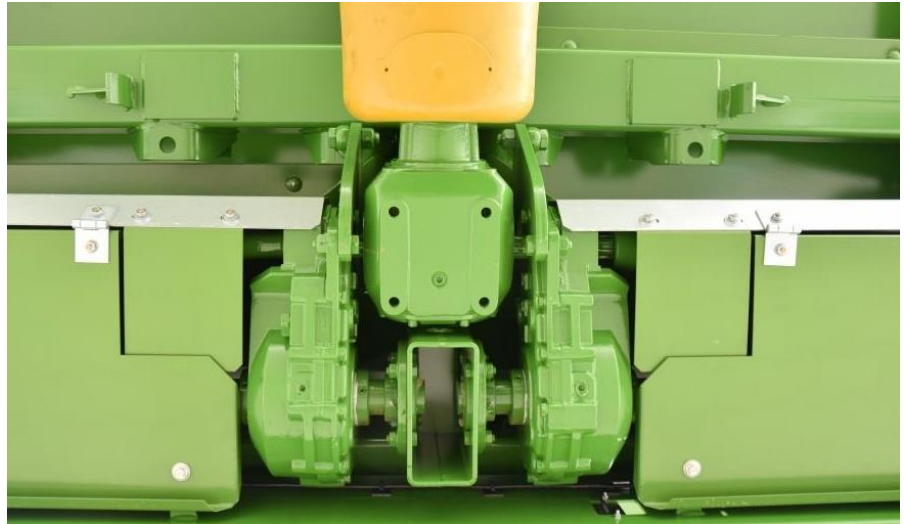

# Cargo space

HTW 35 / 40 / 45 / 50 / 65

## Tailgate

- Wide opening
  - High loads can be reliably discharged
  - Loading with a front loader possible – only without dosing unit
- Reliable mechanical locking of the tailgate
- Use of the tailgate as a dosing gate
  - Throwing distance regulation at S-vehicles



## Tailgate display

- Option
- Display of the tailgate position on the front wall
- Simple, optical controle for the operator





# Cargo space

HTW 35 / 40 / 45 / 50 / 65

## Entrance for cargo space

- Option
- Easy access to the cargo space via a foldable ladder



## Body extensions

- Option
- Height: 200 mm
- Increase of the cargo space



# Cargo space

HTW 35 / 40 / 45 / 50 / 65

**BERGMANN**

*...die Spezialisten*

## Cargo space cover

- Option
- Simple operating
- Fast opening and closing; duration ca. 5 sec
- It adapts of the contour of the load
- Safe transport of the cargo
  - Clean roads
  - Increasing acceptance among citizens
- Nets lie securely on top and cannot lift off – even at high speeds





## Open dosing rollers

- Each with 4 aggressive rip tine rows
  - Smooth running
  - Optimal milling of the shredded material
  - Low forces on the drives
- Perfect, evenly discharge of the material on the silo
  - Loosening of the material
  - Easy spreading on silo with the tractor or loader





# Operation

Via control units of the tractor

## Manual adjustment

- Standard
- The operation of all the hydraulic functions is done via the control valves of the tractor.



- ISOBUS-operation without Terminal
  - Operation via ISOBUS tractor terminal possible
  - Advantages:
    - Less terminals in the tractor cabin
    - High road safety due to unrestricted view to the right
  - Operation via other ISOBUS terminals also possible
  - BERGMANN software AEF certified: „Plug and Play“





### CCI 50

- 5,6“ ISOBUS operating terminal
- **AEF certified**
- Touchscreen und membrane keys
- Expandable with various apps, such as CCI.Command (PT, SC) or CCI.Control (data management, application cards)



### CCI 800

- 8“ ISOBUS operating terminal for displaying one Universal Terminal (UT)
- **AEF certified**
- Multi Touch operation
- Parallel display of several applications: 1 Maxi View and 2 Mini Views
- „ready for agrirouter“



### CCI 1200

- 12,1“ ISOBUS operating terminals for displaying two Universal Terminals (UT)
- **AEF certified**
- Multi Touch operation
- Parallel display of several applications: 2 large windows and 4 Mini Views
- „ready for agrirouter“





### CCI A3

- ISOBUS AUX-N Multifunction lever
  - 3,5" touch screen
  - Visualisation of up to 30 function symbols
  - individuelle Belegung in 3 Ebenen
  - AEF certified
- ✓ With touch control and vibration feedback
- ✓ Very comfortable operation due to the symbols on the touch keys

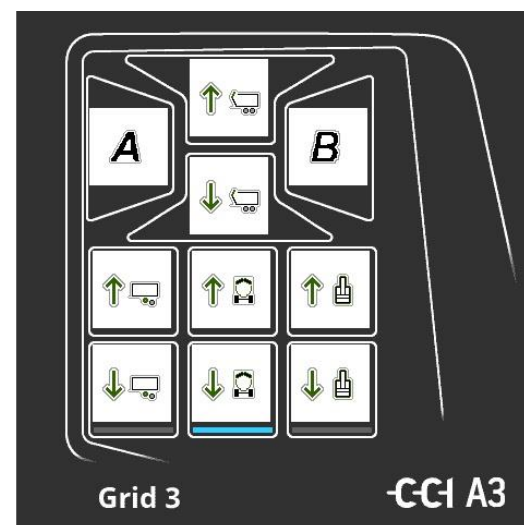

# Weighing system

HTW 40 / 45 / 50 / 65

**BERGMANN**

...die Spezialisten

## Hydraulic Weighing system

- Option
- Display via Digistar SLC 2810
- Measured values are recorded by pressure sensors in the chassis hydraulics and the K80 coupling with integrated weighing cell
- Weighing accuracy: +/- 5 %
- ✓ Enables a highly accurate control of the harvested quantities and the loaded mass
- ✓ Transport vehicles can be loaded according to the maximum permissible weight



## Weighing system via ISOBUS

- Option
- Current payload is displayed directly in the clear user interface
- Easy documentation via ISOBUS-Task-Controller

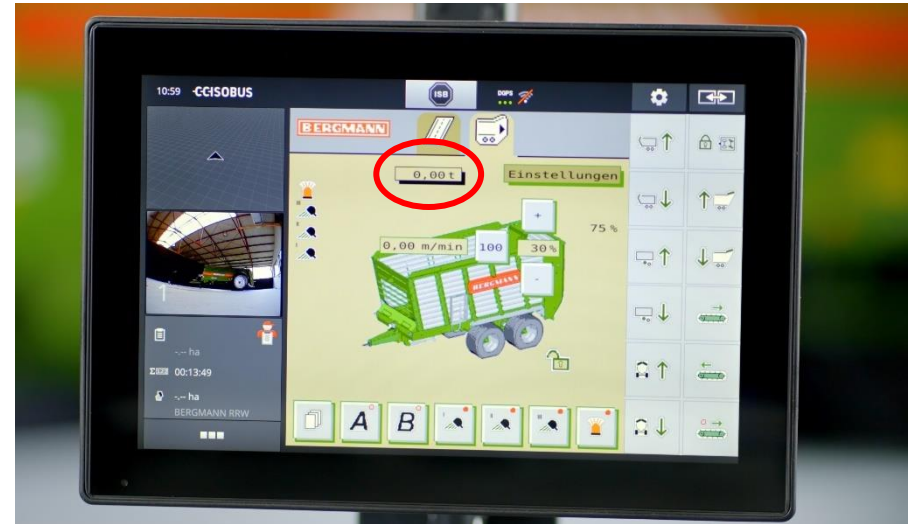



- Camera
  - Coloured cameras
- Videomonitor
  - Display of camera view on the videomonitor VM1
  - The camera view can also be displayed directly on the ISOBUS-terminals CCI 50 / CCI 800 / CCI 1200
- Miniplexer
  - The Miniplexer is required when two cameras are in use

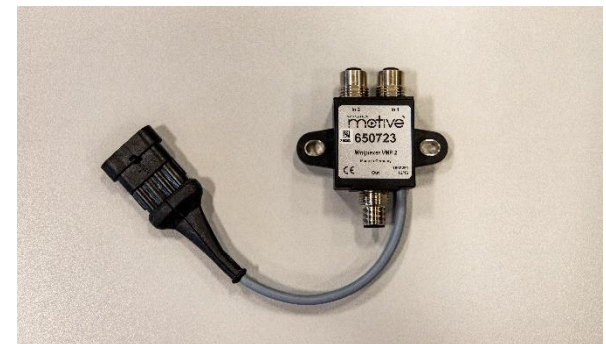

### Working lights

- Option
- LED working lights
- Different positions possible
  - Cargo space
  - Rear end
  - By request also other positions
- It is operated either via a switch box or easy via the ISOBUS user interface.



## Automatic central lubrication system

- Option
- Automatic lubrication of the whole machine  
minimaler Wartungsaufwand
- ✓ Minimum maintenance
- ✓ Better lubrication of moving parts
- ✓ Less need for grease





# HTW – Forage transport trailers

Special construction



## HT special bodies

- Special bodies on request



# Thank you for your attention!

